

Sold

1

350 x 350  
HICK COLUMN

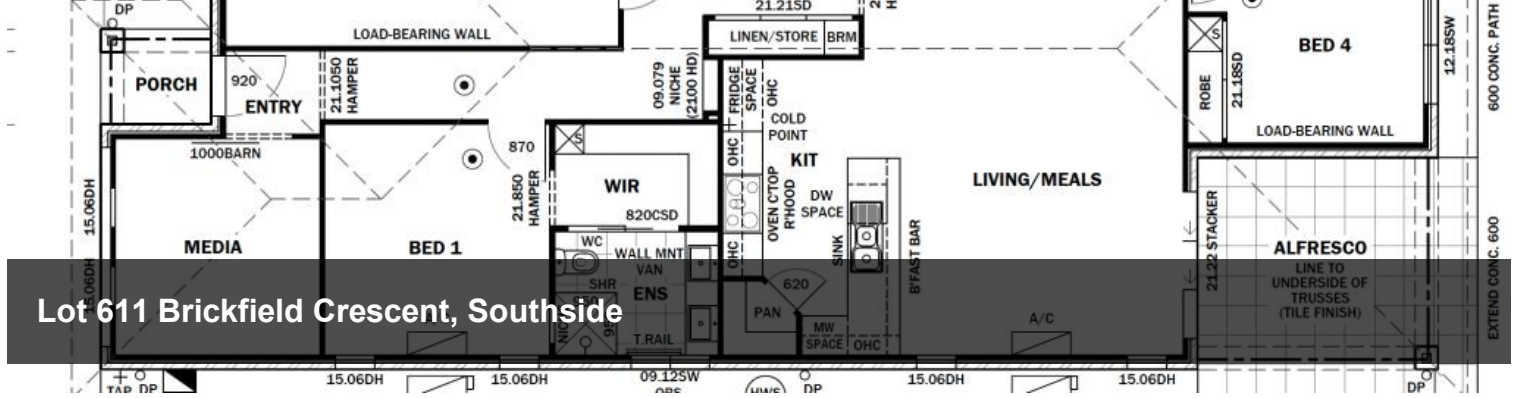

Lot 611 Brickfield Crescent, Southside



## BRAND NEW FAMILY HOME

### Key Features:

- 4 bedrooms, 2 car garage, 2 Living Rooms, 2 bathrooms
- 2550 Ceiling height
- Fully Rendered
- Fully fenced (Colourbond)
- Fully turfed and landscaped -includes Palmetto turf and a 21 day Lawn care package
- Stone tops throughout, soft close drawers to kitchen.
- Full Termite treatment to frame, trusses, slab & penetrations
- Driveway
- Letterbox
- Clothesline
- Ceiling fans (alfresco included)
- Air conditioners 1 x 5.2 & 1 x 2.6 KW Fujitsu to Master bedroom and living room
- Full floor coverings (tiles and carpet)
- Inclusion- Dishwasher, 900mm Oven/cooktop, Range hood
- Fully insulated to roof
- Security Screens throughout

4 2 2 2 679 m<sup>2</sup>

**Price** SOLD for \$699,000

**Property Type** Residential

**Property ID** 843

**Land Area** 679 m<sup>2</sup>

### AGENT DETAILS

Pete Angle - 0438 864 158

Keryn Angle - 0434 379 533

### OFFICE DETAILS

One Agency Gympie

0438 864 158

**ONE** AGENCY GYMPIE

Although ONE Agency Gympie has provided all information related to this property to the best of our knowledge and resources, we shall not be held

accountable or responsible for its accuracy. ONE Agency Gympie urge all buyers to conduct their own independent research and consult their own professionals to conduct due diligence before purchasing.

*The above information provided has been furnished to us by the vendor/s. We have not verified whether or not that information is accurate and do not have any belief in one way or the other in its accuracy. We do not accept any responsibility to any person for its accuracy and do no more than pass it on. All interested parties should make and rely upon their own inquiries in order to determine whether or not this information is in fact accurate.*